



Physio Magneto Neo (PMST-Neo) User Manual



Warning

Dear user:

Thanks for using our device, to make sure a correct operation, following points must be noted:

Please read this guide in detail and keep it well for reference.

- ◆◆ Please follow the guide to assemble and operate the machine correctly.
- ◆◆ Please do not remove and change any accessories of the machine.
- ◆◆ Open the machine is not allowed except authorized or instructed by manufacturer
- ◆◆ Please contact us if there is any problem during operation.

This product does not belong to medical device, please don't use for disease treatment!

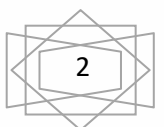

Parts Introduction

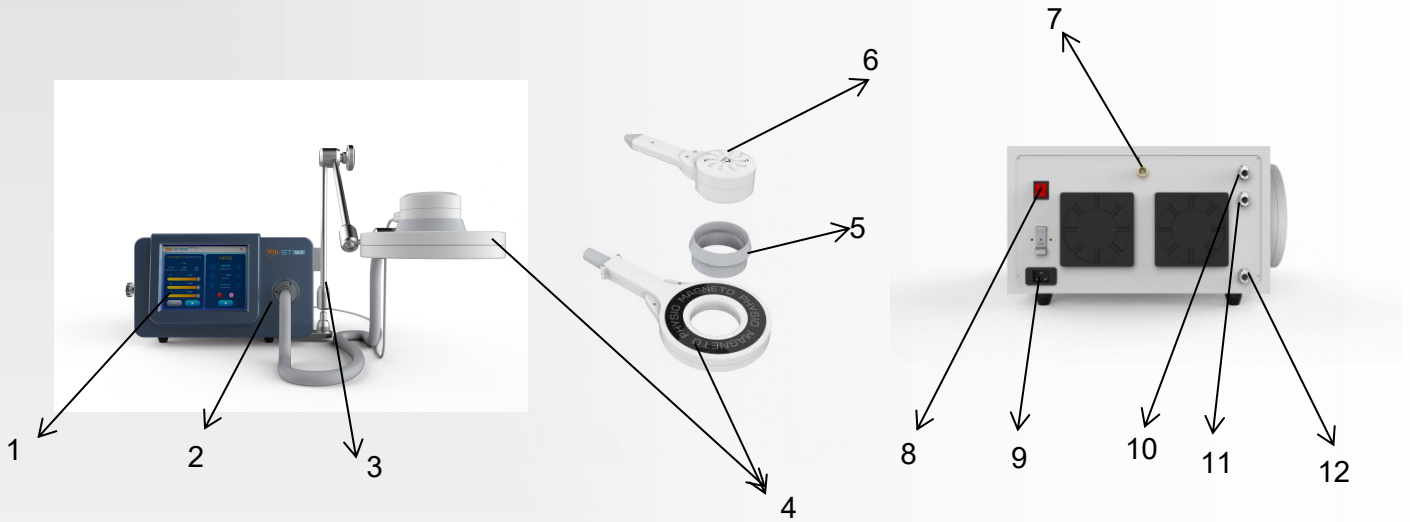

- 1.10.4" Screen
- 2.Magneto Hand Piece Connector
- 3.Holding arm
- 4.Magneto Handle
- 5.Silicone Case
- 6.NIRS Handle
- 7.NIRS Handle connector
- 8.Power Switch
- 9.Power Socket
- 10.Inlet
- 11.Overflow
- 12.Outlet

Accessories



PM handle



Holding arm



NIRS Handle

Technology Background

Magneto Therapy pulses a magnetic field into the body, creating an extraordinary healing effect. The results are less pain, reduction in swelling, and increased range of motion in the affected areas. Damaged cells are reenergized by boosting electrical charges within the cell that restore it to its normal healthy state. Cellular metabolism increases, blood cells are regenerated, circulation is improved, and absorption of oxygen is increased by upwards of 200%. The immune system becomes healthier and the liver, kidneys, and colon are better able to eliminate waste and toxins.

Effects of Magneto Therapy

- reduces pain
- improves superficial and deep blood circulation
- improves tissue regeneration
- stimulates venous and lymphatic drainage
- affects the restoration of metabolic balance activity

Indications For Treatment

- various muscular pathologies (contracture, muscle tears, bruises and swelling)
 - injuries, osteoarticular distractions and wear of the joints (shoulder, hip, knee, ankle joints)
 - pathology of the elbow, wrist and arm (epicondylitis, tendinitis, carpal tunnel syndrome)
 - cervical, thoracic and lumbar pathology
 - inflammation and damage to the Achilles tendon, and patellar ligament
 - tendonitis and calcination in the area of the shoulder
- Joint acute and chronic edema

Technology Background

Near-infrared spectroscopy is a spectrum that can penetrate deep into the skin and subcutaneous tissues, it can cause collagen hyperplasia, structural reorganization, cause the resonance of atoms and molecules in human cells, through resonance absorption, friction between molecules to form a thermal reaction, promote the rise of deep subcutaneous temperature.

Effects of NIRS Therapy

- make the healing process easier
- improve blood circulation
- pain relief , analgesic effect
- decreases muscle spasme
- increase in endorphins influencing the pain gate mechanism
- acceleration of healing and tissue repair
- increases the sensory nerve conduction velocity
- make the skin a better conducto

Indications For Treatment

- Arthritis, Synovitis,
- Muscle ache, tenosynovitis, frozen shoulder
- Pelvic inflammatory disease, adnexitis, chronic pancreatitis, celiac disease
- Chronic appendicitis, chronic gastroenteritis
- Knee effusion,
- Meniscus damage

PM Therapy Operation

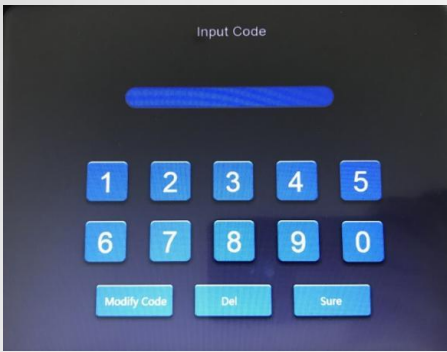

Fig 1

In interface as (Fig1)
Input default password: “888888” to enter interface as (Fig 2) shows.

Notes: “advanced setting” is for manufacturer only.



Fig 2

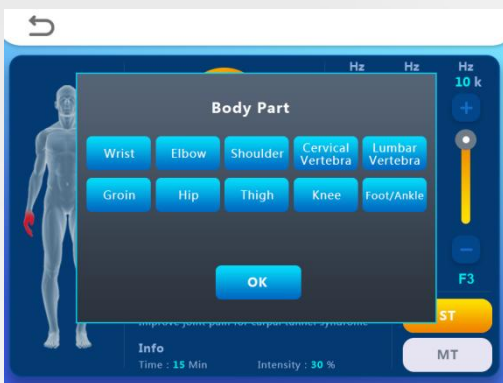

Fig 3



Fig 4

1. chose the body part that you want to treat as (Fig 3)
2. Adjust the Energy intensity : Adjust the Energy according to different client and different treatment site. Click on “+” and “-” to set, the range is from 5% (weak) to 100%(strong).(Fig 4)
3. ST mode: super transduction,1000-3000Hz,The system automatically recommends treatment parameters for each Part.With ST mode, the frequency can't be adjusted.(Fig 5)
4. Adjust the Frequency intensity : Adjust the Frequency according to different client and different treatment site. Click on “+” and “-” to set, F1 rang: 1 to 35 F2 rang:1 to 50 F3 rang:1 to 28. (Fig 6)
5. MT mode: Magneto transduction, 1-100HZ, The frequency can be adjusted according to different customers.(Fig 7)



Fig 5



Fig 6

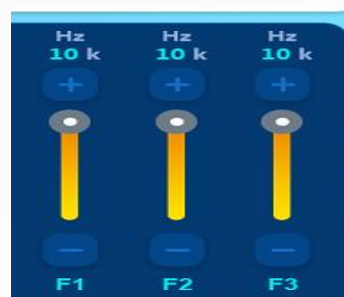

Fig 7

NIRS Therapy Operation

In interface as (Fig1)

Input default password: “ 888888 ” to enter interface as (Fig 2) shows.



Fig 2

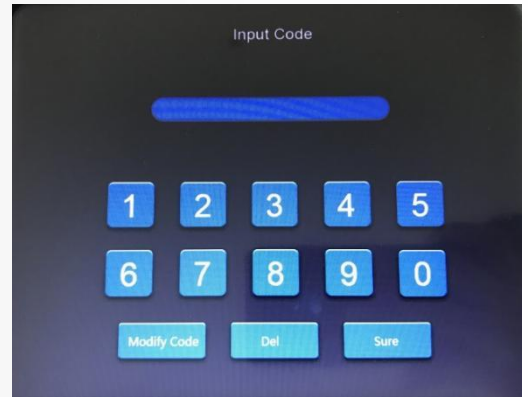

Fig 1

1. Adjust the Energy intensity : Adjust the Energy according to different client and different treatment site. Click on “+” and “-” to set, the range is from 10% (weak) to 100%(strong).(Fig 3)

2. Adjust the Frequency : Adjust the different frequency according to different client and different treatment site. Click on “+” and “-” to set, the range is from Continuity to 100HZ .(Fig 3)

3. Press the red button to control the visible light switch, the wavelength of visible light is 620-660Nm;

Press the pink button to control the invisible light switch, the wavelength of invisible light is 940Nm;

Press the red and pink buttons at the same time, visible light and invisible light work at the same time..(Fig 4)



Fig 3



Fig 4

How does the PM-ST NEO treatment

Physio magneto and Near infrared spectroscopy can be treated separately or combined together. The combination of the two can improve the treatment effect and shorten the healing and repair time.

Magnetic field pulses combined with near-infrared spectroscopy are safe and side-effect-free treatments. Physiotherapy is very comfortable, the physiotherapy handle ring is placed on the painful area being treated, and there is no need to undress. Magnetic field pulses and near-infrared spectroscopy can transmit energy to your painful area and act to achieve therapeutic effects.

The closer the handle ring is to the treatment site, the greater the energy.

For the physio magneto ,each therapy session lasts approximately 5-20 minutes, and a session requires 6-8 sessions, depending on the severity of the condition and response to therapy

For the near infrared spectroscopy ,each therapy session lasts approximately 20-30 minutes, and a session requires 6-8 sessions, depending on the severity of the condition and response to therapy



Physio Magneto Parameters- MT Mode

| Site | Energy | Frequency | | | Time | Course treatment | Interval time |
|-------------------|--------|-----------|----|----|------|------------------|---------------|
| | | F1 | F2 | F3 | | | |
| Hand | 30 | 7 | 25 | 10 | 15 | 6-8 | 3-5days |
| Elbow | 30 | 7 | 25 | 10 | 15 | 6-8 | 3-5days |
| Shoulder | 50 | 7 | 25 | 10 | 20 | 6-8 | 3-5days |
| Cervical Vertebra | 50 | 7 | 25 | 10 | 20 | 6-8 | 3-5days |
| Lumbar Vertebra | 50 | 7 | 25 | 10 | 20 | 6-8 | 3-5days |
| Groin | 45 | 25 | 45 | 15 | 20 | 6-8 | 3-5days |
| Hip | 40 | 25 | 45 | 15 | 20 | 6-8 | 3-5days |
| Thighs | 45 | 7 | 25 | 10 | 20 | 6-8 | 3-5days |
| Knee | 40 | 7 | 25 | 10 | 20 | 6-8 | 3-5days |
| Foot/Ankle | 35 | 7 | 25 | 10 | 15 | 6-8 | 3-5days |

Physio Magneto Parameters- ST Mode

| Site | Energy | Frequency | | | Time | Course treatment | Interval time |
|-------------------|--------|-----------|----|----|------|------------------|---------------|
| | | F1 | F2 | F3 | | | |
| Hand | 30 | 1K | 3K | 2K | 15 | 6-8 | 3-5days |
| Elbow | 30 | 1K | 3K | 2K | 15 | 6-8 | 3-5days |
| Shoulder | 50 | 1K | 3K | 2K | 20 | 6-8 | 3-5days |
| Cervical Vertebra | 50 | 1K | 3K | 2K | 20 | 6-8 | 3-5days |
| Lumbar Vertebra | 50 | 1K | 3K | 2K | 20 | 6-8 | 3-5days |
| Groin | 45 | 1K | 3K | 2K | 20 | 6-8 | 3-5days |
| Hip | 40 | 1K | 3K | 2K | 20 | 6-8 | 3-5days |
| Thighs | 45 | 1K | 3K | 2K | 20 | 6-8 | 3-5days |
| Knee | 40 | 1K | 3K | 2K | 20 | 6-8 | 3-5days |
| Foot/Ankle | 35 | 1K | 3K | 2K | 15 | 6-8 | 3-5days |

Taking knee physiotherapy as an example, magnetic field pulse combined with near-infrared light physiotherapy



1. Connect the handle
2. Put the handle of the near-spectrum light into the ring of the magnetic ring handle
3. The treated area can be clothed or exposed
4. Adjust the position of the support arm (**note: the surface of the magnetic ring handle without pattern is the treatment surface, close to the treatment part, the closer the distance between the handle surface and the treatment part, the greater the energy**)
5. Select ST mode, adjust the treatment parameters on the interface, and click  to start treatment



6. Separate physiotherapy for different parts of the physio magneto and near infrared spectroscopy, they can work at the same time

Forbiddens

- 1.The eyes and the surrounding area, the myocardium, the spinal cord, the gonads, the kidneys and the liver.
- 2.Blood disorders, coagulation problems or the use of anticoagulants.
- 3.Polypus in the area of treatment.
- 4.Thrombosis.
- 5.Tumor diseases.
- 6.Polyneuropathy.
- 7.Growing cartilage in children.
- 8.Therapy using corticoids.
- 9.Inapplicable on areas in proximity to large nerve bundles, bundles, blood vessels, the spinal cord and the head.

Possible Side Effects

1. Erythema or swelling can temporarily occur in the treated area.
- 2.Loss of bodily sensation or itching can temporarily occur in the treated area.
- 3.Skin damage after previous corticoid therapy.
- 4.Shockwave application can cause undesirable heart activity.

Accessories List

| | |
|-----------------|------|
| 1.Host | 1pcs |
| 2.PM Handle | 1pcs |
| 3.Holding arm | 1pcs |
| 4.NIRS Handle | 1pcs |
| 5.Silicone Case | 1pcs |