

PMST  LOOP

# PMST LOOP PRO MAX

Physio Magneto Super Transduction Loop



# Attention

Respected user:

Thank you for choosing the instruments which carefully designed and manufactured by our company.

In order to better utilize the product, we sincerely recommend:

- ◆◆ Please read this manual carefully before using the instrument.
- ◆◆ Please install, use and operate correctly according to the requirements in the manual.
- ◆◆ Do not disassemble or modify any parts of this machine.
- ◆◆ Except for authorized personnel of the company, it is strictly forbidden to open the cover and disassemble the host.
- ◆◆ Non-professionals are strictly forbidden to carry out repairs and renovations.
- ◆◆ If there is any malfunction during the operation, please contact us.

Due to continuous improvement, update, and replacement of the product, the products received may not be exactly same as the illustration in the manual. We sincerely apologize.

**Notice: Please read this manual carefully before operating this machine.**

# **Set Up Guide**

## **Safety precautions**

**CHECK** - Inspect all electrical leads (power cord, extension cord, surge protector, etc.) before use to be sure that they have not been damaged or severed. If any lead has been damaged, then DO NOT use it. Use a different lead or order a replacement.

**CHECK** - Inspect all of the Applicators before use to be sure that they have not been damaged or severed (i.e. exposing the copper wires inside). If the insulation on any of the Applicators has been damaged, then DO NOT use that Applicator. Use a different Applicator or order a replacement.

**CHECK** - Make sure that there is nothing covering/obstructing the fan, and that there is no dust nearby that can be sucked into the fan.

**CHECK** - Avoid using outlets controlled by a light dimmer. The magnetic field generated by the driver may cause small electronics like those inside of light dimmer to malfunction it may create a surge of electricity that may damage either your machine or the light dimmer attached to the outlet, Make sure the outlet you use is not controlled by a light dimmer before you power the unit on.

**IMPORTANT** - We recommend that you use a surge protector so that you may operate the unit without any electrical interruptions. Connect the surge protector to your wall socket or extension lead, and plug the machine's power cord directly into the surge protector. This should allow you to avoid any electrical interruptions that may take place.

**IMPORTANT** - Ensure that the machine is powered OFF before connecting or changing Applicators, and ensure that the probes are securely locked in place before powering on again.

**IMPORTANT** - When using a single Applicator, ensure that the Dummy Cord is connected to the set of Probe Connectors on the PEMF machine.

**TRANSPORT** - Always move the machine using the handles on the case. DO NOT pull on the probe leads or power cord. Pulling and tugging on the wires may

damage your device and the wires. Always use the handles to transport, adjust and swivel your machine.

**TRANSPORT** - DO NOT drop or toss the machine. While the case is durable, its main function is to provide external protection to the sensitive electronics inside. Dropping and tossing the machine may cause internal damage. Always put the machine down with care, and make sure it is fastened securely (to ensure minimal movement) during travel.

**STORAGE** - DO NOT store any of the Applicators in the machine case, as it can press down on the front panel of the driver and damage it, Store the Applicators separately.

**WATER** - DO NOT expose the machine to water or allow it to get wet in any way. If water gets inside the machine, wait overnight or longer for it to dry out and DO NOT power it on during this time. If you receive your unit and the front panel is wet with condensation from the changing temperatures during shipping, make sure to dry it well (especially around the probe connections) and wait overnight for it to dry internally before powering up.

## **Warning**



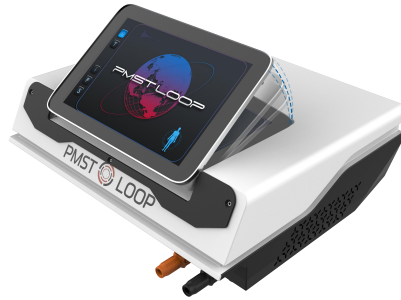

- To change loop hand piece, must turn machine OFF .
- NEVER change loop hand piece while machine is running.
- DO NOT PLACE the loop on the ground in the vicinity of the animal, to ensure they can't stand on, or chew the it.
- START treatment with low intensity, below the animal's pain threshold.
- THE LOOP CAN come into direct contact with the animal.

# Physio Magneto Therapy Machine

## 【1】 Product Appearance (For reference only, subject to the actual product)

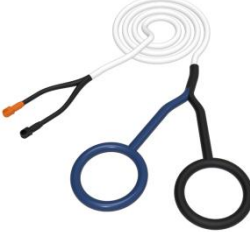

## 【2】 Standard accessories

			
Machine*1	Large Loop*1	Butterfly Loop*1	Power line*1

### 【3】 Technical Parameters

Power Consumption	850W	Dimension of package	60cm*54.5cm*44cm
Magnetic intensity	1000-6000Gauss	Gross Weight	32.5KG
Pulse Frequency	1-10Hz	IP rating	IP 31
Oscillation	4500Hz	Attached loops:	single loop and butterfly loop
Fused	1.5Amp		

### 【4】 Structure of the machine and how to install it



Structure: ①Foldable Screen ②Loop Plug ③Power Switch ④Cooling Fan ⑤Fuse ⑥Socket

**【5】 Use Process For Human use**

**(1) Install handles**



**(2) Plug in and power on**

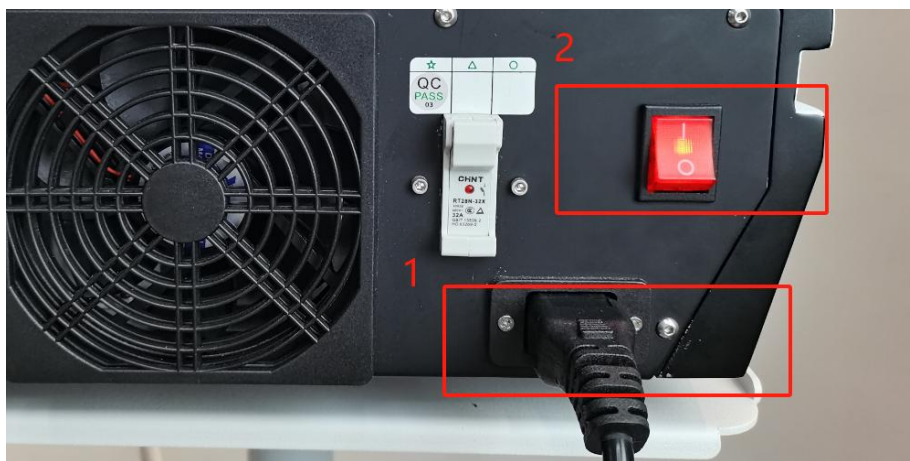

**(3) Enter password: "888888"**

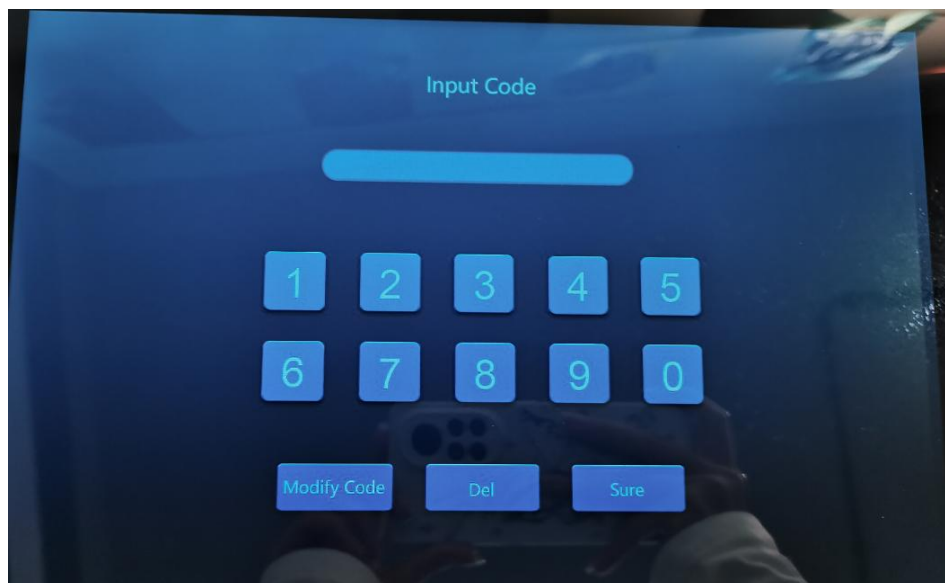

#### (4) Main Interface

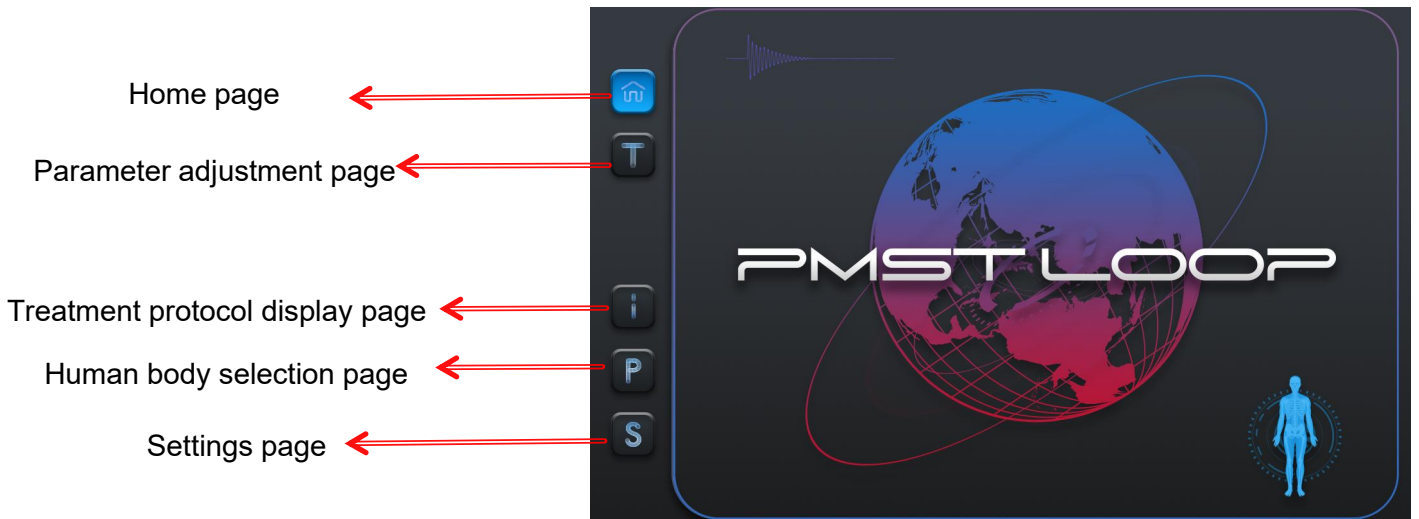

#### (5) Adjustment Parameter

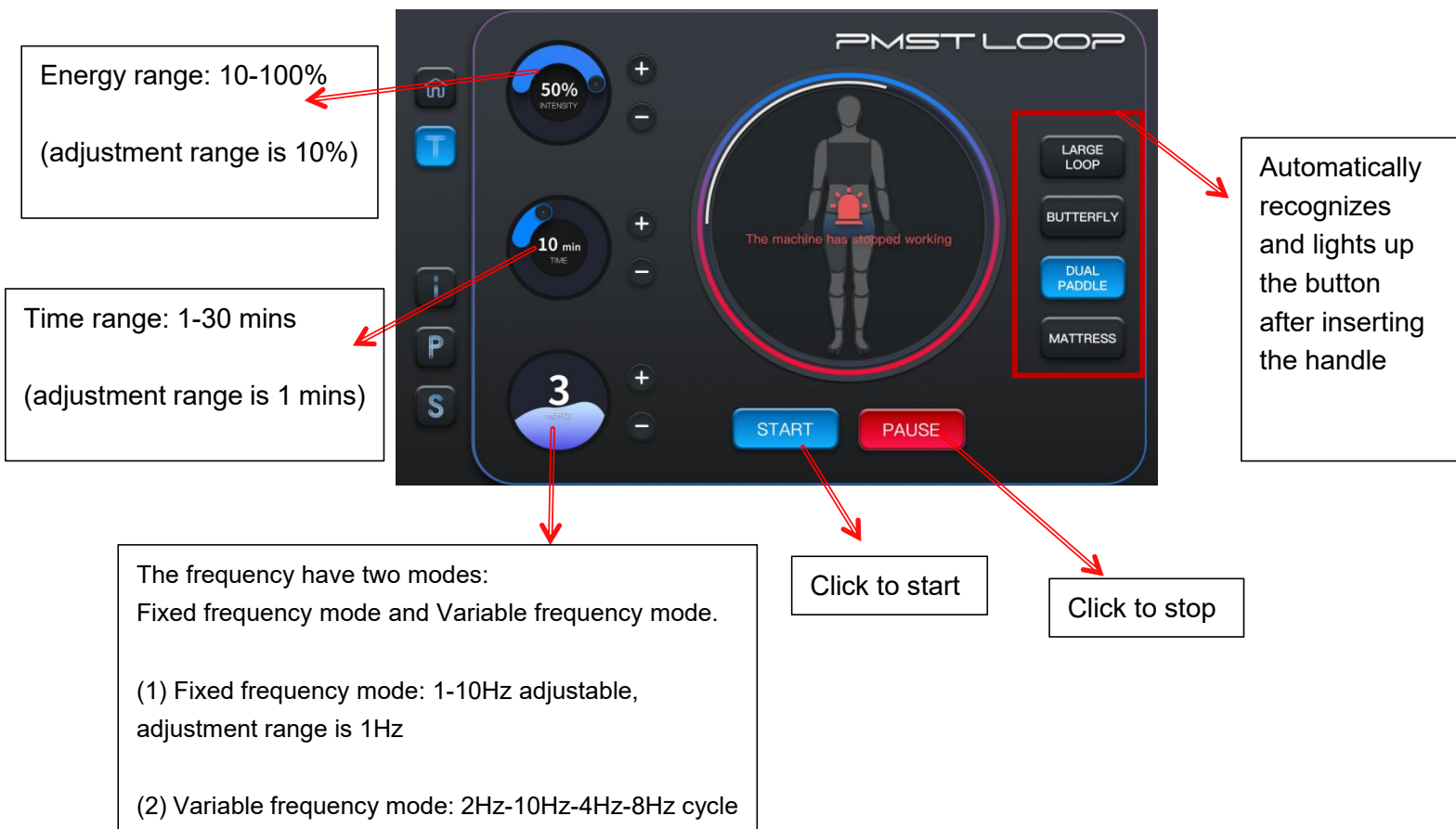



## (6) Treatment protocol display

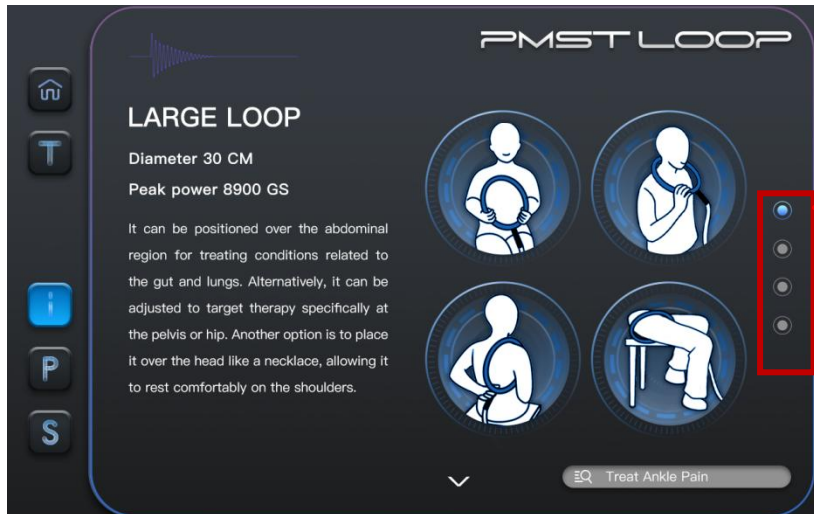

## (7) Human body selection

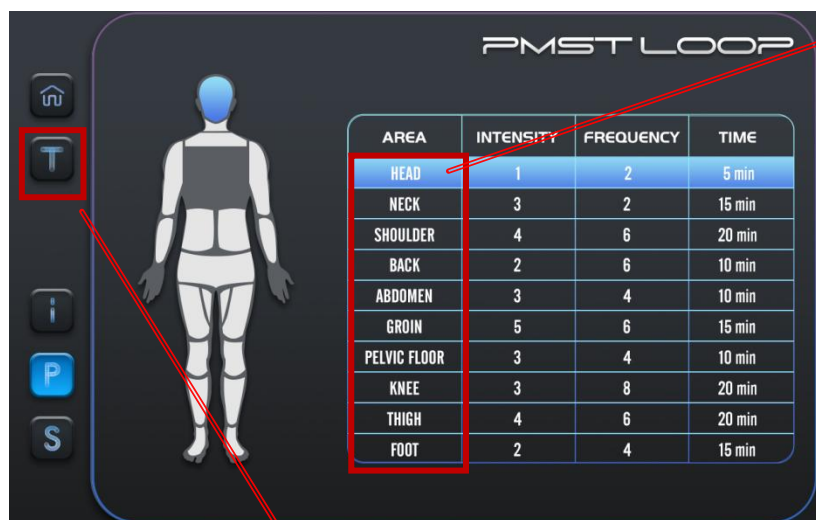

At this time, you can return to the parameter interface to adjust the parameters, or directly use the preset parameters for treatment.

**(8) Settings page**

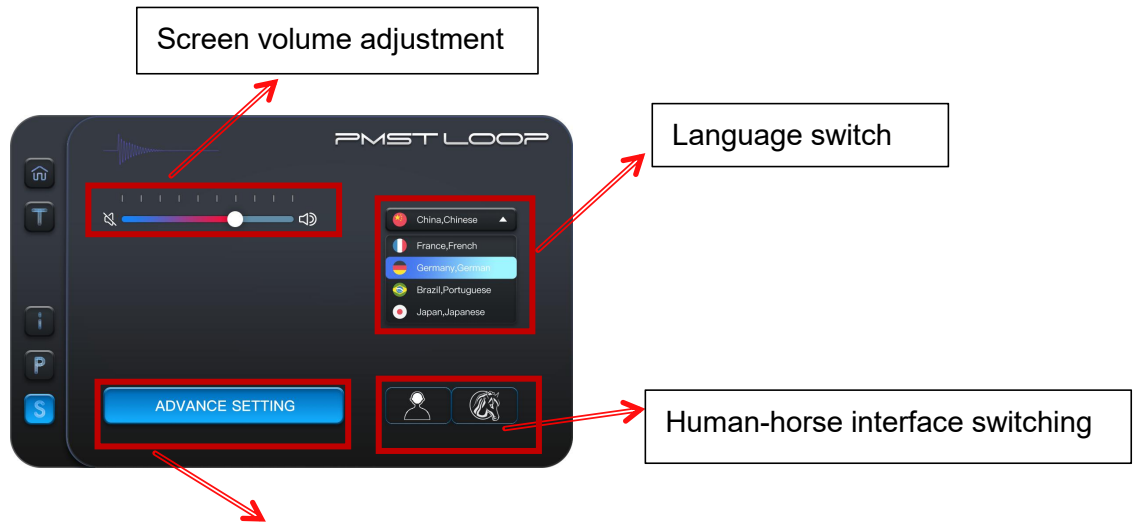

Advanced settings: After clicking on the human interface/horse interface, you will enter the password input interface.  
 You can switch interfaces after entering the correct password.

**【6】 Treatment Recommendation**

Area	Energy	Frequency	Time	Sessions	Interval
Head	1	2	5min	6-8	Twice a week
Neck	3	2	15min	6-8	Twice a week
Shoulder	4	6	20min	6-8	Twice a week
Back	2	6	10min	6-8	Twice a week
Abdomen	3	4	10min	6-8	Twice a week
Groin	5	6	15min	6-8	Twice a week
PELVIC FLOOR	3	4	10min	6-8	Twice a week
Knee	3	8	20min	6-8	Twice a week
Thigh	4	6	20min	6-8	Twice a week
Foot/Ankle	2	4	15min	6-8	Twice a week

**【7】 More pictures**

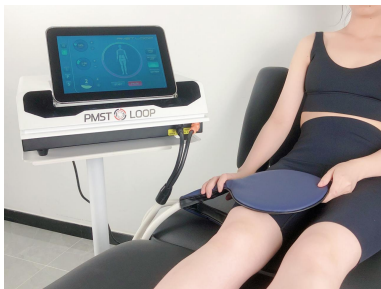

## 【6】 Use Process For Animal use

### (1) Install handles



### (2) Plug in and power on

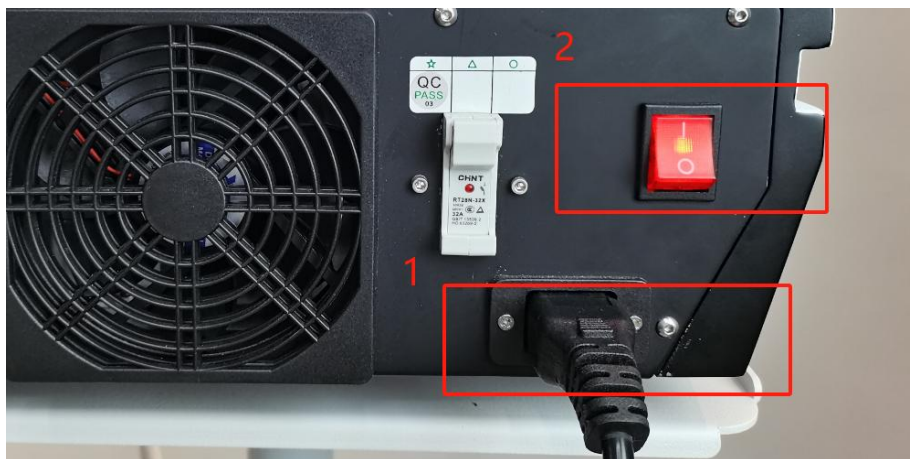

### (3) Enter password: "888888"

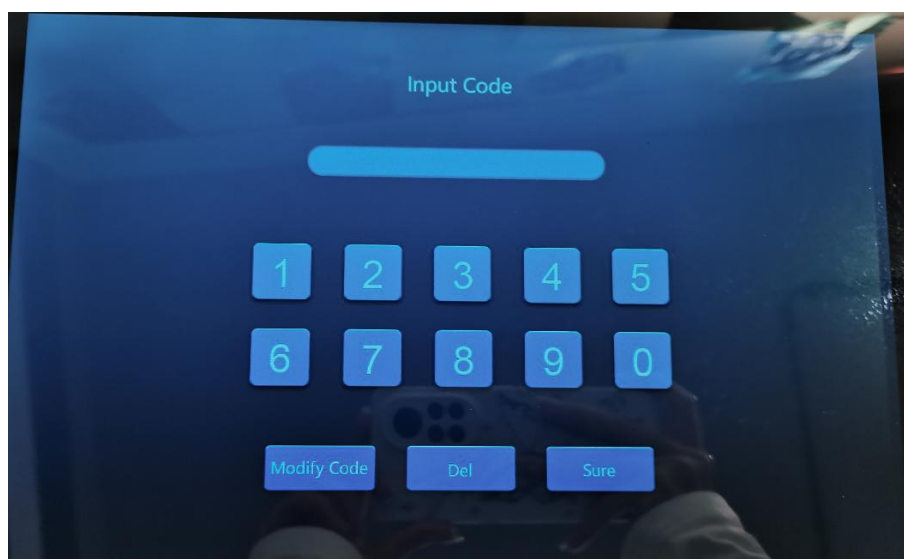

#### (4) Main Interface

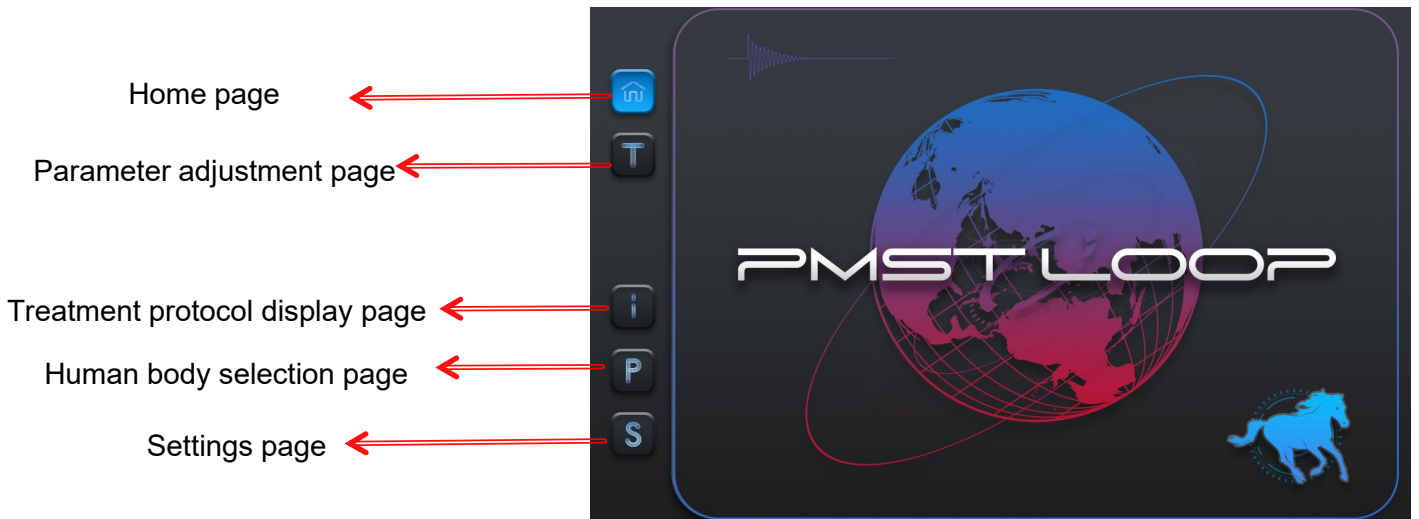

#### (5) Adjustment Parameter

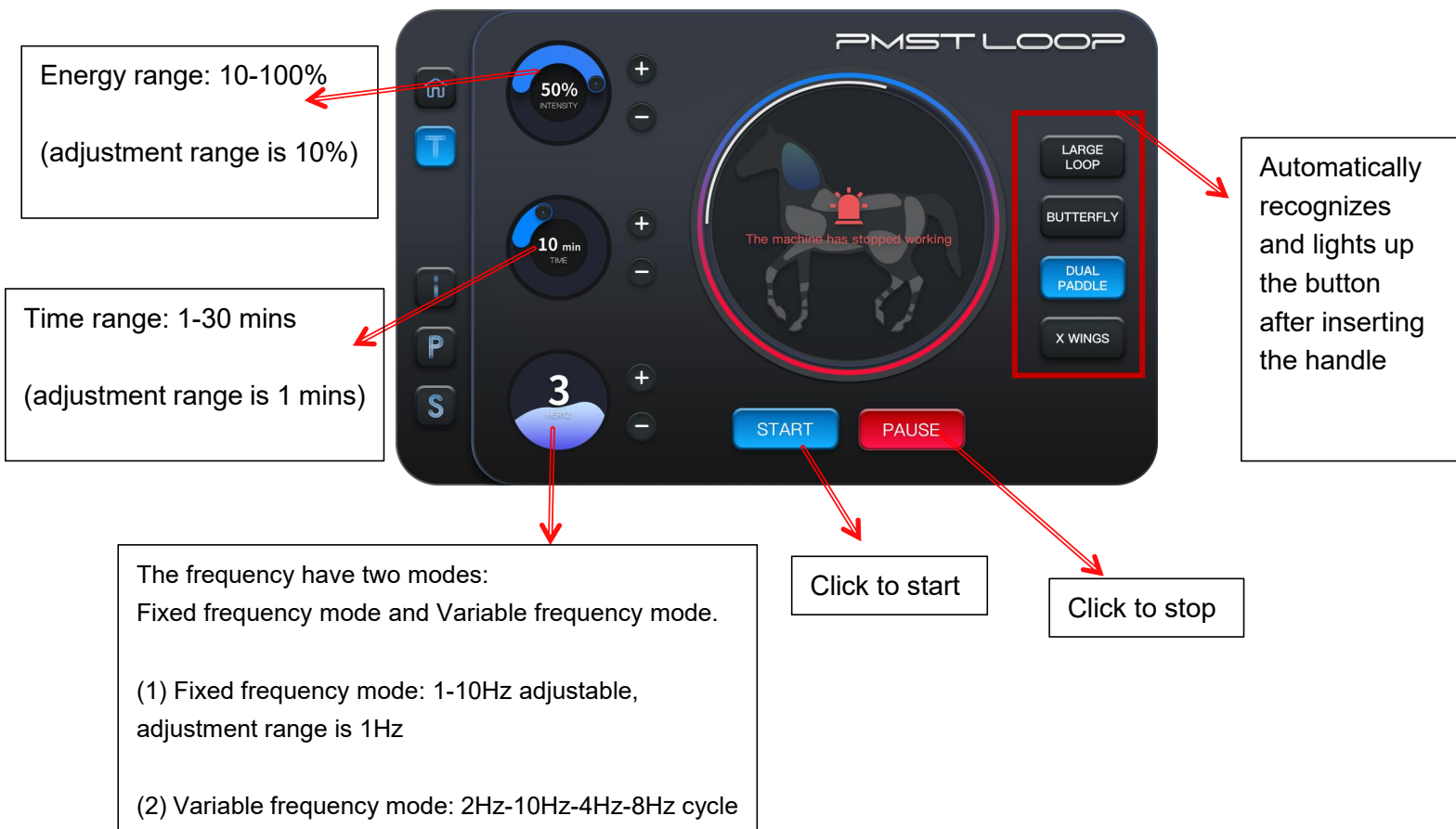

## (6) Treatment protocol display

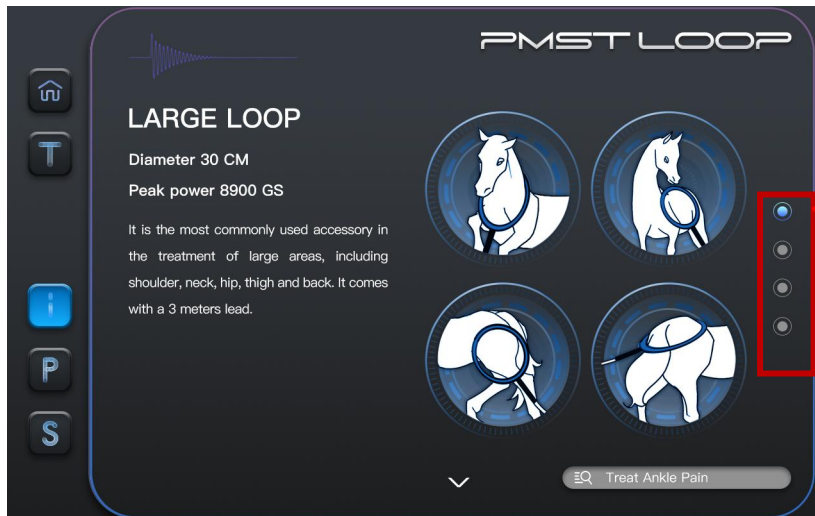

Click here to switch pictures of different handles

## (7) Human body selection

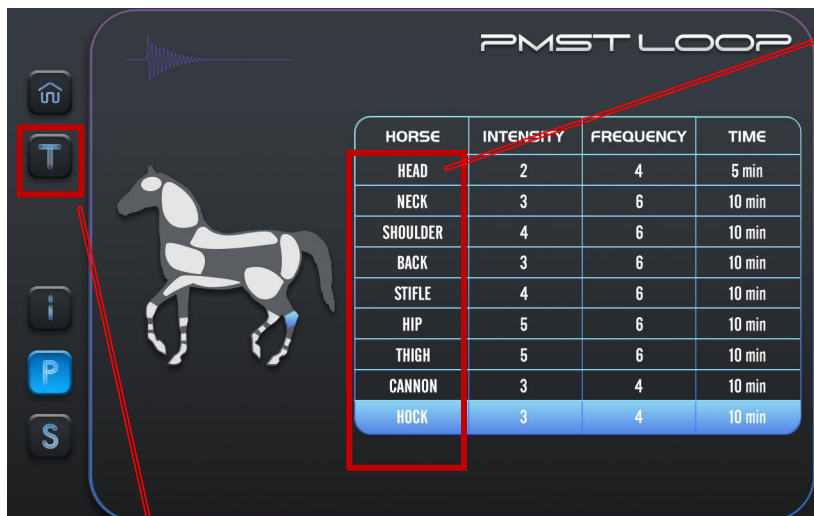

Rows 2-11 are selectable, click on any square, the corresponding row number will light up, the whole row will light up, and the corresponding body part will light up

At this time, you can return to the parameter interface to adjust the parameters, or directly use the preset parameters for treatment.

**(8) Settings page**

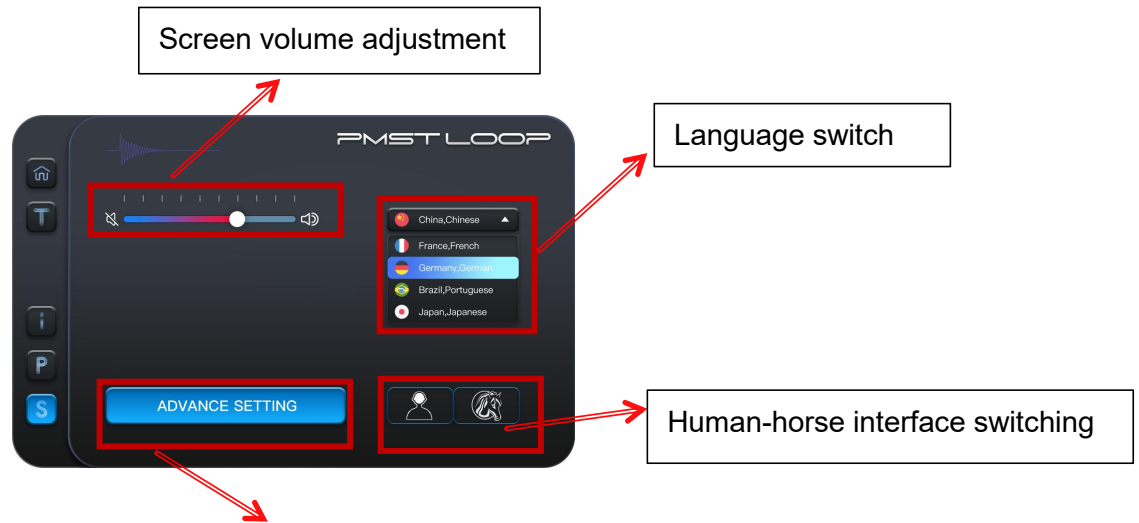

Advanced settings: After clicking on the human interface/horse interface, you will enter the password input interface.  
 You can switch interfaces after entering the correct password.

**【6】 Treatment Recommendation**

Area	Energy	Frequency	Time	Sessions	Interval
Head	2	4	5min	6-8	Twice a week
Neck	3	6	10min	6-8	Twice a week
Shoulder	4	6	10min	6-8	Twice a week
Back	3	6	10min	6-8	Twice a week
Stifle	4	6	10min	6-8	Twice a week
Hip	5	6	10min	6-8	Twice a week
Thigh	5	6	10min	6-8	Twice a week
Cannon	3	4	10min	6-8	Twice a week
Hock	3	4	10min	6-8	Twice a week

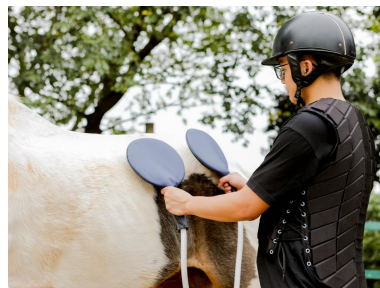

**NOTICE:** When we treat the head of the horse, the intensity must be adjusted to the lowest energy.

**【7】 More pictures**



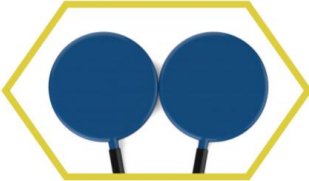

## 【8】 Optional accessories

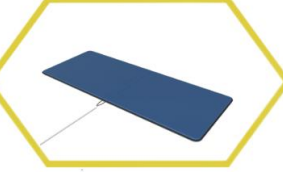
 A yellow hexagonal frame containing two blue circular pads on black stands.	 A yellow hexagonal frame containing a blue ring-shaped coil with a black connector.	 A yellow hexagonal frame containing a blue rectangular mat on a white stand.
Double pad (for human and horse)	X-wing (for horse)	Mat (for human)

## 【9】 Magneto therapy

### 1. Treatment theory

PMST LOOP's ring type coil applicator applies pulsed electromagnetic field and transduces pulse into body tissues, thereby accelerating the healing process for sports injuries, chronic pain, and degenerative joint diseases.

### 2. Indications

#### (1) Degenerative joint diseases

Signs of wear and tear, e.g. arthrosis (knee, hip, hands, shoulder, elbow), herniated disc, spondylarthrosis.

#### (2) Pain therapy

(Chronic) pain, e.g. back pain, lumbalgia, tension, radiculopathies, heel pain.

#### (3) Sport injuries

(Chronic) inflammation of tendons and joints, tendon overload syndrome, osteitis pubis.

### 3. Contraindication

- ◆ Vascular diseases present in or near the treatment area
- ◆ Local infections in the treatment area
- ◆ Around malignant or benign tumours
- ◆ Directly on cartilage surfaces or near the small facet joints of the spinal column
- ◆ Directly over implanted electronic devices such as pacemakers, analgesic pumps, etc.

- ◆ In areas, in which mechanical energy in the form of vibrations may lead to tissue damage such as metal implants after a fracture

#### 4. Precautions to be taken before treatment

- ◆ If there is only a pure metal object in the vicinity of the treatment site, vibration and heat will occur depending on the distance of the metal object.
- ◆ If there is an implanted circuit in the body, such as a pacemaker, or other circuit device. Strong magnetic fields can cause power failures or damage internal chips.
- ◆ ID cards, car keys, access cards, and other wireless devices near the magnetic ring will be damaged.

#### 5. Recommended steps

- (1) Open the case
- (2) Position the applicator above the treatment area
- (3) Insert the loop plug
- (4) Adjust intensity, frequency and treatment time according to the type of person and the specificity of the treatment.
- (5) Press the “start button”